

DISCLAIMER:
It is the responsibility of the developer to design foundations to accommodate all proposed and existing tree and shrub planting. The developers engineers should satisfy themselves that the trees are safe distances from drainage runs and services and that no planting falls in service strips. If any planting should be considered to be compromising services or underground structures in anyway, they should contact the landscape designer as soon as possible so that the drawing can be revised.

The Client / Employer is obliged to take due care in ensuring that only competent contractors who have an adequate health and safety policy are employed.

A suitable method of foundation must be provided allowing for existing ground conditions. Any suspect or fluid ground, contaminates within the ground should be further investigated by a suitable expert. Any earthwork constructions shown indicate typical slopes for guidance only and should be further investigated by a suitable expert.

Where existing trees are to be retained they should be subject to a full arboricultural inspection for safety. All trees are to be planted so as to ensure they are a minimum of 5 metres from buildings and 3 metres from drainage and services. A suitable method of construction is to be provided to accommodate the proposed tree planting.

KEY

- Area of Existing Vegetation
- Proposed Multi - Stem Planting
- Proposed Tree Planting With Tree Pit Area Indicated
- Proposed Ornamental Shrub Planting
- Proposed Native Hedgerow 1
- Proposed Native Hedgerow 2
- Seed Supplied By Germinall Seeds WFG - 20 Species Rich Lawn
- Proposed Timber Knee Rail 600mm High
- Re-Root 600mm Depth Root Barrier

Landscaping Schedule					
Trees					
Species	Height	Girth	Specification	Pot Size	Number of Plants
Acer campestre 'Streetwise'	20-25cm		Rootball	5L	5 No.
Shrubs					
Species	Density	Height	Specification	Pot Size	Number of Plants
Cornus alba 'Elegantissima'	3/m ²	40-60cm		3L	60 No.
Cornus stolonifera 'Flaviramea'	3/m ²	60-80cm		3L	81 No.
Euonymus fortunei 'Emerald Gaiety'	4/m ²	20-30cm		2L	111 No.
Hypericum moserianum	4/m ²	30-40cm		3L	114 No.
Prunus laurocerasus 'Otto Luyken'	3/m ²	30-40cm		3L	178 No.
Hedgerow 1					
Species	Density	Lin m	Height	Pot Size	Number of Plants
Buxus sempervirens	4/m		40-60cm	5L	303 No.
Hedgerow 2					
Species	Density	Lin m	Height	Pot Size	Number of Plants
Ligustrum vulgare	2/m		100-125cm	5L	108 No.

1.0 DRAWING INFORMATION
1.1 This Mansfield King drawing is based upon **RGP Architects Drawing: 9450 PL 10 Rev A (15.10.14) 'Proposed External Works'**
1.2 These drawing notes are intended for guidance only and must be read in conjunction with our Full NBS Landscape Specification

2.0 SITE PREPARATION
2.1 All topsoiled areas to be cleared of rocks larger than 50mm diameter and any other debris that may interfere with the planting establishment.
2.2 Prior to planting all landscaped areas shall be cultivated to 200 depth mm (min) and maintained in a weed free condition.
2.3 Tree planting in relation to manhole covers and statutory runs is to be co-ordinated with main contractor and in accordance with statutory guidelines for approval by the landscape designer.

3.0 TOPSOILING
3.1 All subsoil prior to topsoiling should conform to BS 8601 (2013) specification
3.2 All topsoiling operations are to be carried out to BS 3882 (2007) specification for topsoil and requirements for use.
3.3 Prior to topsoiling all sub soil is to be thoroughly 'ripped' mechanically with excavator to relieve compaction.
3.4 All topsoiling to be carried out to the following depths:
Ornamental Planting Beds: 450mm min depth
Lawned Areas: 150mm min depth
Specimen Shrub: 0.5m x 0.5m diameter x 450mm depth
See MK BK WA 02 Drawing For Tree Pit Details

4.0 PLANTING
4.1 All plants and planting to comply with the requirements of all current / relevant British Standard
4.2 Specifications including BS 3936: Part1 (1992) and part 4 (1984) and BS 5326 (1975) where applicable, BS4428 (1989) and the BALI / Nursery Trade Tender Document (5th Edition 1986).
4.3 During cultivation, a 50mm depth of PAS-100 compost and N-mag Lite (3-17-10 + 5% Mg) controlled release granular fertilizer is to be incorporated into the top 150mm depth of topsoil.
4.4 Supply and spread Ornamental Grade Bark Mulch at 50mm depth to all hedge and ornamental planting beds.
4.5 All shrubs are to be planted at the specified densities as shown on the planting schedule.
4.6 All plants are to be thoroughly watered prior to and following planting.
4.7 Planting adjacent to car park area road kerbs is to be set back 250mm min from the back of kerb to allow room for the plants to establish and reduce damage to cars, with the unplanted area mulched only.
4.8 All hedges to be planted at specified densities as shown in the planting schedule. Excavate continuous trench to suitable depth in relation to container size and the nursery line of the plant, ensure plants are equally spaced in straight lines. Add PAS 100 grade compost and fertilizer to topsoil prior to backfilling.

5.0 TREE PLANTING
5.1 All trees to be planted as shown ensuring a minimum of 5 meters from buildings and 3 meters from drainage. A suitable method of foundation allowing for existing ground conditions is provided to accommodate the proposed tree planting.
5.2 See MK BK WA 02 Drawing For Tree Pit Details

6.0 WATERING
6.1 Watering shall be carried out as necessary to maintain the healthy growth of all plants and trees.
6.2 No dedicated, mains-supplied irrigation systems (including pop-up sprinklers and hoses) are specified and planting will rely solely on manual watering by building occupier or landlord.

7.0 LANDSCAPE MAINTENANCE
7.1 Regular landscape maintenance visits are required throughout the growing season. All areas are to be kept in a weed and litter free condition using a combination of chemical spray and hand weeding.
7.2 Maintenance preparations to include watering, formative pruning and disease control and re-mulching. Mowing is to be carried out to maintain grass sward to maximum 50mm height and all arising are to be removed from site.
7.3 All newly planted shrubs to be maintained below 1.8m in height.
7.4 All tree stakes and underground guys are to be checked monthly and adjusted as appropriate.
7.4 Landscape maintenance is to be carried out during the 12 month defects period following completion, with replacement required for failed stock
7.6 The Landscape Contractor should make allowance to top up bark mulch to required depth at 12 months following completion.

8.0 PLANNING CONDITION
8.1 Any retained or newly planted trees, shrubs or hedges which die, become seriously damaged or diseased or are removed or destroyed within a period of 5 years from the date of planting shall be replaced during the next planting season with specimens of the same size and species unless otherwise agreed in writing by the Local Planning Authority.

KNEE RAIL DETAIL NTS

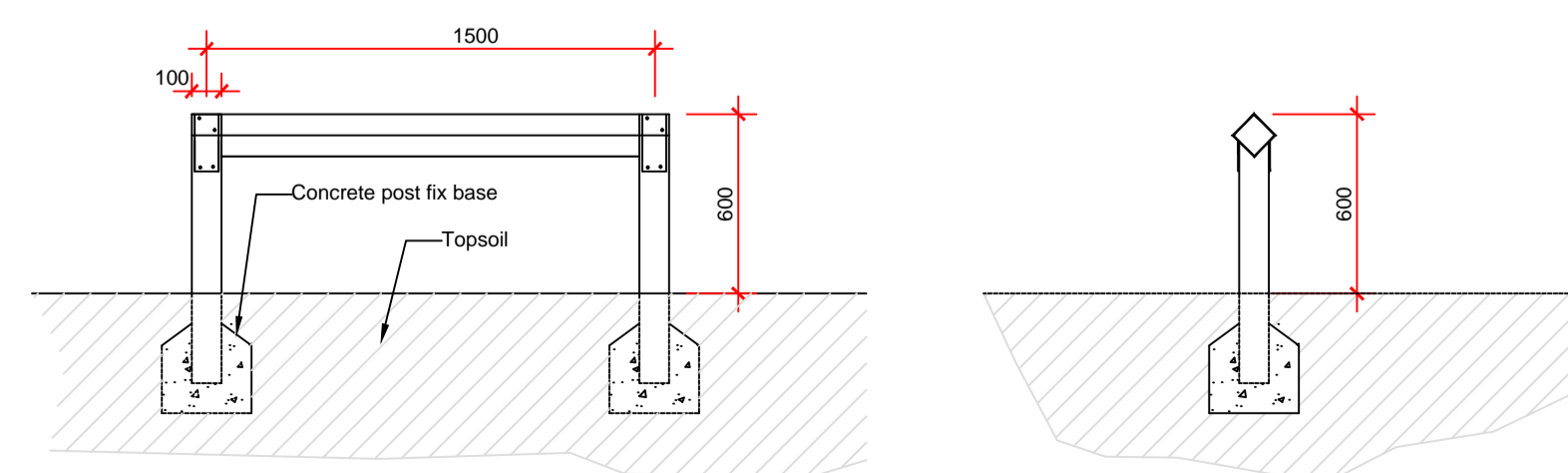

Rev:	Comments:	Date:
A	Changed as per clients comments	30,10,14

© This drawing and the building works depicted are the copyright of Mansfield King Landscape Design Ltd and may not be reproduced or amended except by written permission. No liability will be accepted for amendments made by other persons.



Landscape Design, Management & Consultancy

Title: Landscaping Plan
Client: Bowmer & Kirkland
Project: Waitrose Trinity Road Uttoxeter

DWG No. MK BK WA 01 (Rev A)
Status: For Approval Date: 20,10,14
Drawn: JG Office: Knoll
Checked: JK Scale: 1:250 @ A1

The Knoll, Leicester Road, Earl Shilton, Leicester, LE9 7TJ
Tel: (01455) 850250 Fax: (01455) 850450
email: jon.king@mansfieldking.co.uk